

K.I. Sawyer (Airport Area)

Inset

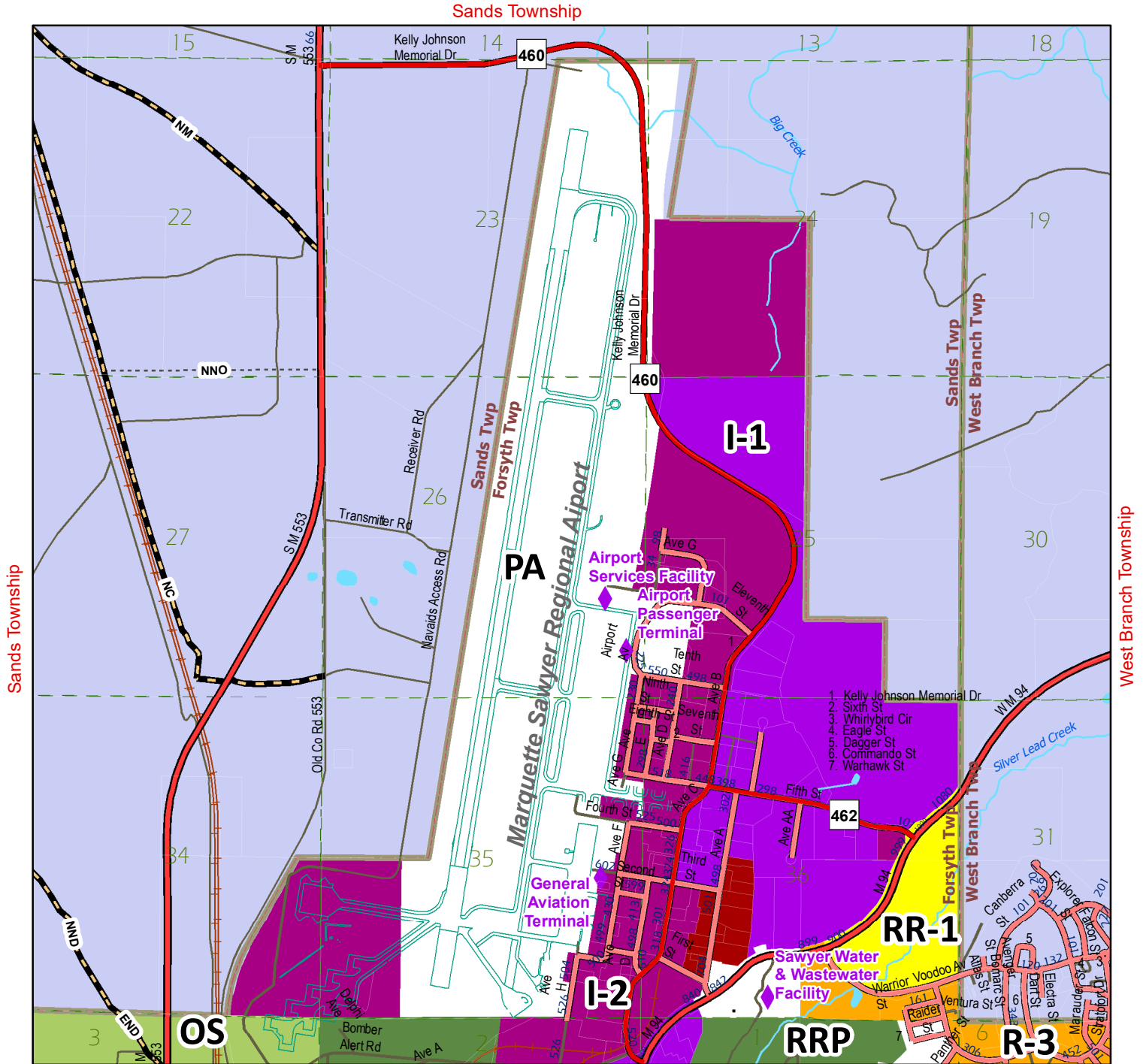

Residential Area, Pg. 2

© Marquette County Resource Management / Development Department, 1.5.2025.

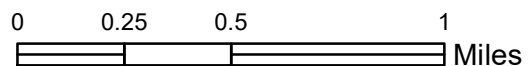

K.I. Sawyer (Residential)

Inset

Airport Area, Page 1

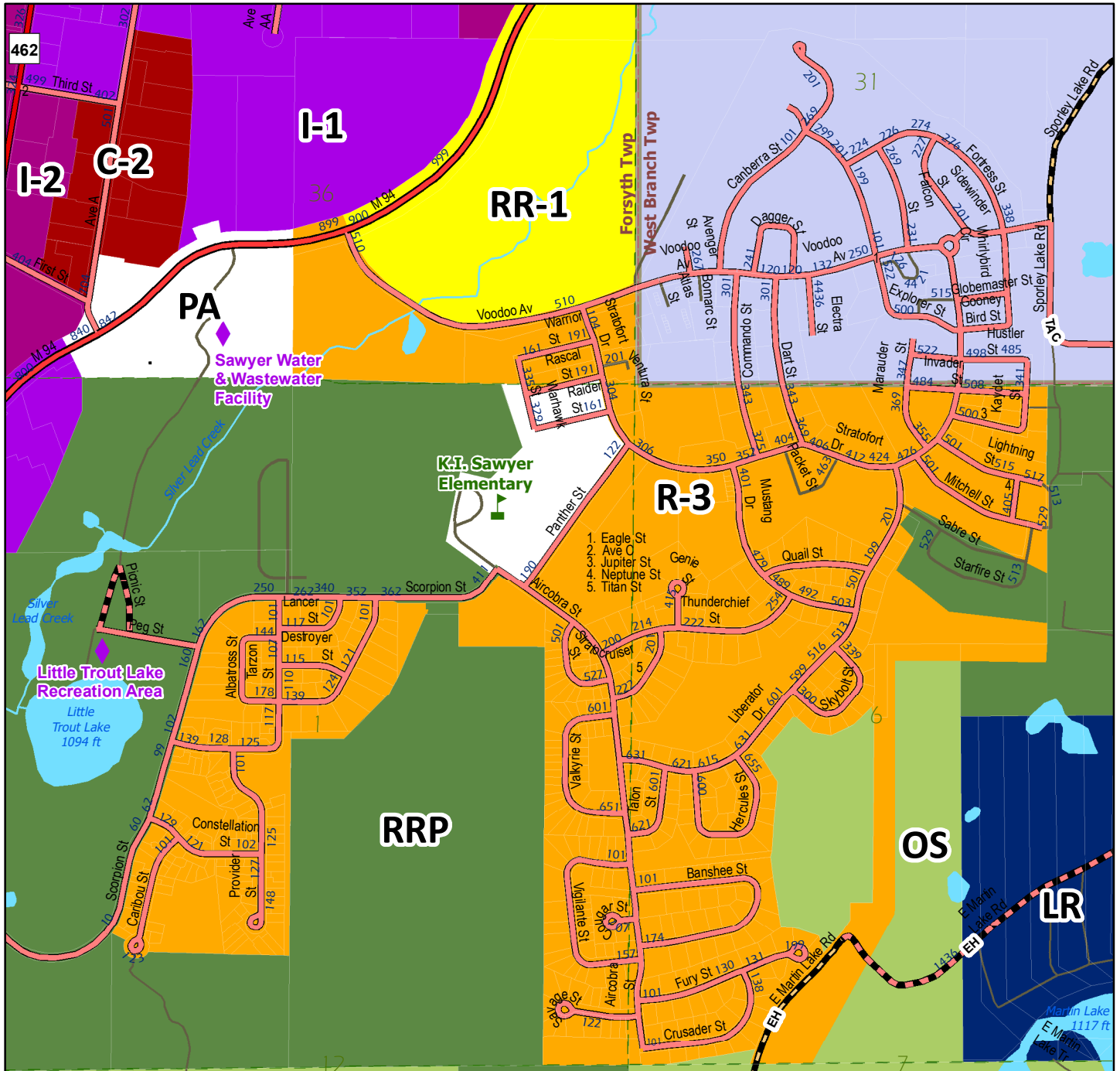

T.45N.-R.25W., Page 4

T.45N.-R.24W., Page 7

T.45N.-R.25W., Page 4

© Marquette County Resource Management / Development Department, 1.5.2025.

Forsyth Township Zoning Districts	
	C-2 Commercial
	I-1 Industrial
	I-2 Industrial
	LR Lake Residential
	OS Open Space
	PA Public Area
	R-3 Multiple Family Residential
	RR-1 Rural Residential
	RRP Recreation-Resource Production

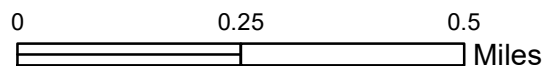
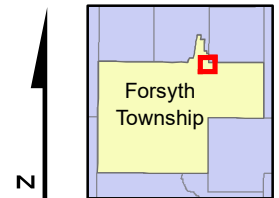

Forsyth Twp. (NW)

T.45N.-R.26W.

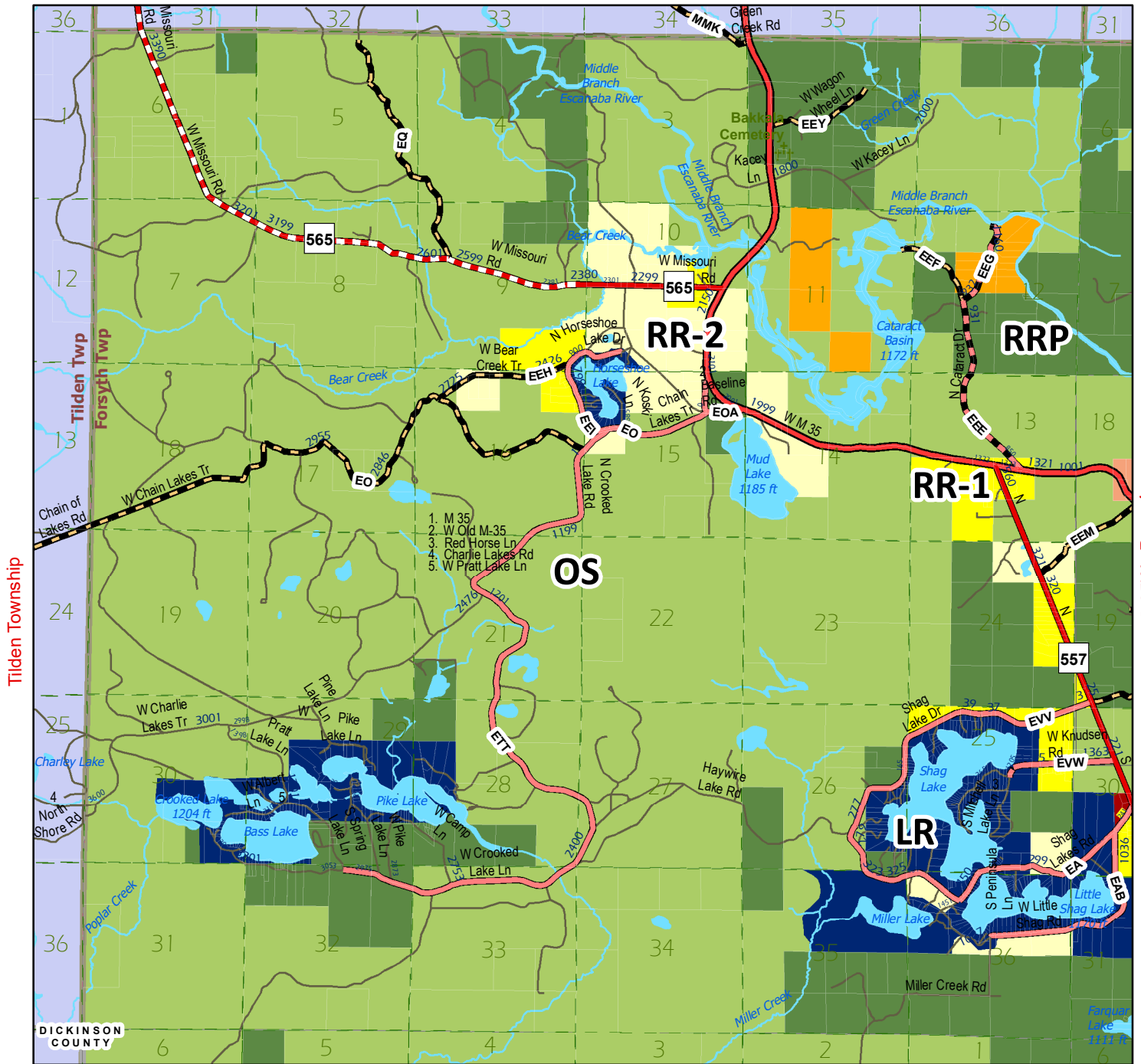

T.44N.-R.26W., Page 9

© Marquette County Resource Management / Development Department, 1.5.2025.

Forsyth Township Zoning Districts	
■	C-2 Commercial
■	LR Lake Residential
■	OS Open Space
■	R-2 Family Residential
■	R-3 Multiple Family Residential
■	RR-1 Rural Residential
■	RR-2 Rural Residential
■	RRP Recreation-Resource Production

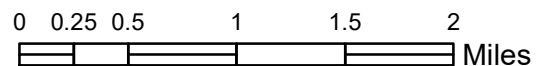
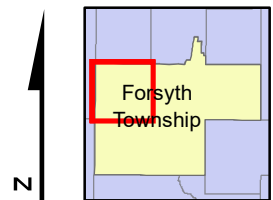

3

Gwinn Area (Forsyth Twp.)

T.45N.-R.25W.

T.46N.-R.25W., Page 1

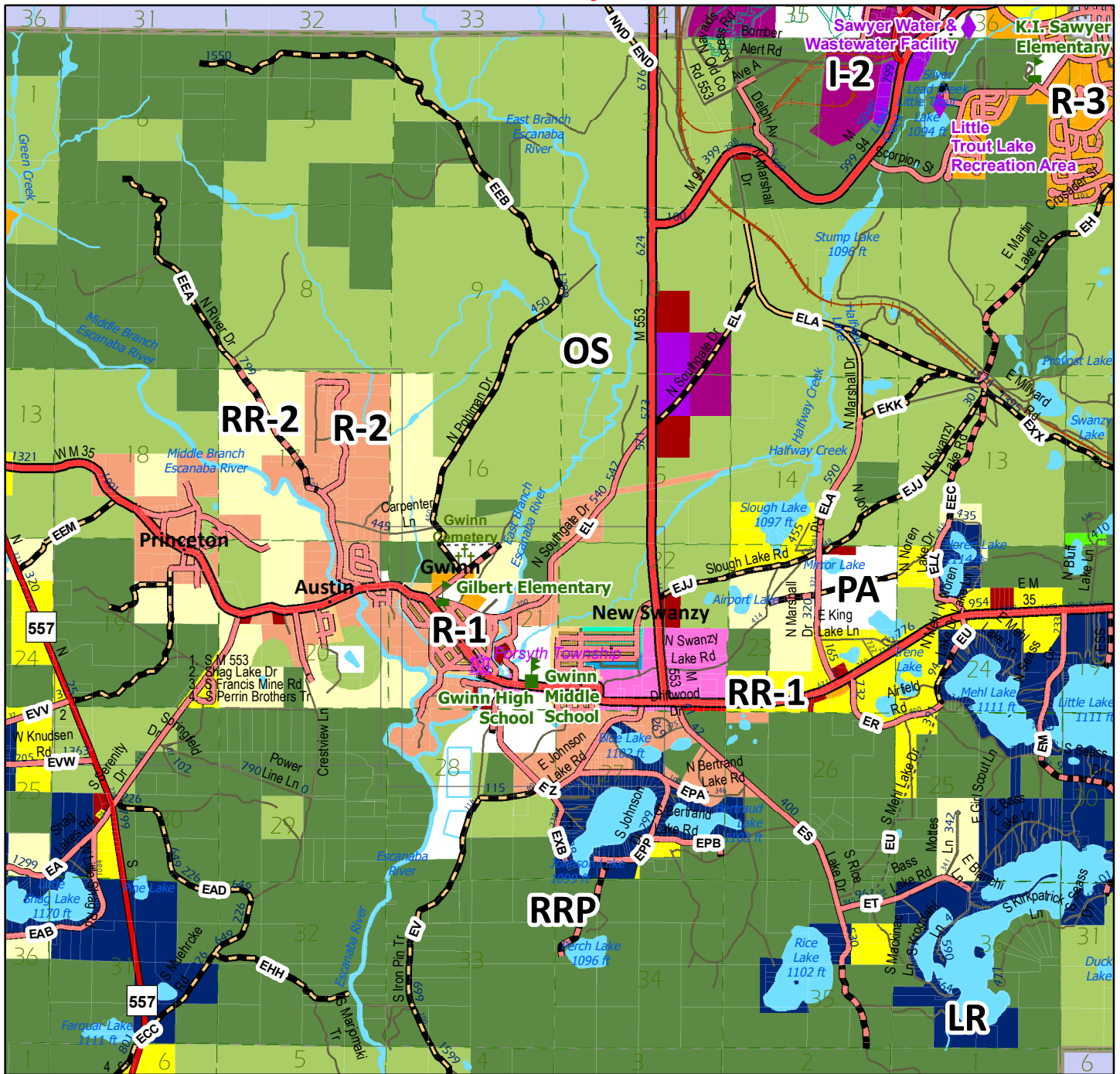

T.45N.-R.26W., Page 3

T.45N.-R.24W., Page 7

T.44N.-R.25W., Page 10

© Marquette County Resource Management / Development Department, 1.5.2025.

Forsyth Township Zoning Districts	
	MU Mixed Use
	C-1 Commercial
	C-2 Commercial
	I-1 Industrial
	I-2 Industrial
	LR Lake Residential
	MH-1 Mobile Home Residential
	MH-2 Mobile Home Park
	OS Open Space
	PA Public Area
	R-1 Family Residential
	R-2 Family Residential
	R-3 Multiple Family Residential
	RR-1 Rural Residential
	RR-2 Rural Residential
	SD Seasonal Dwelling
	RRP Recreation-Resource Production

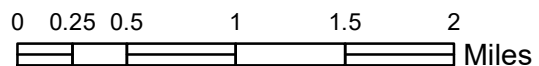
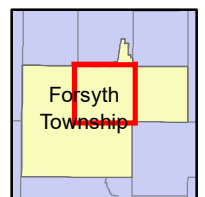

4

T.45N.-R.25W., Page 4

T.45N.-R.26W., Page 3

Gwinn, Page 6

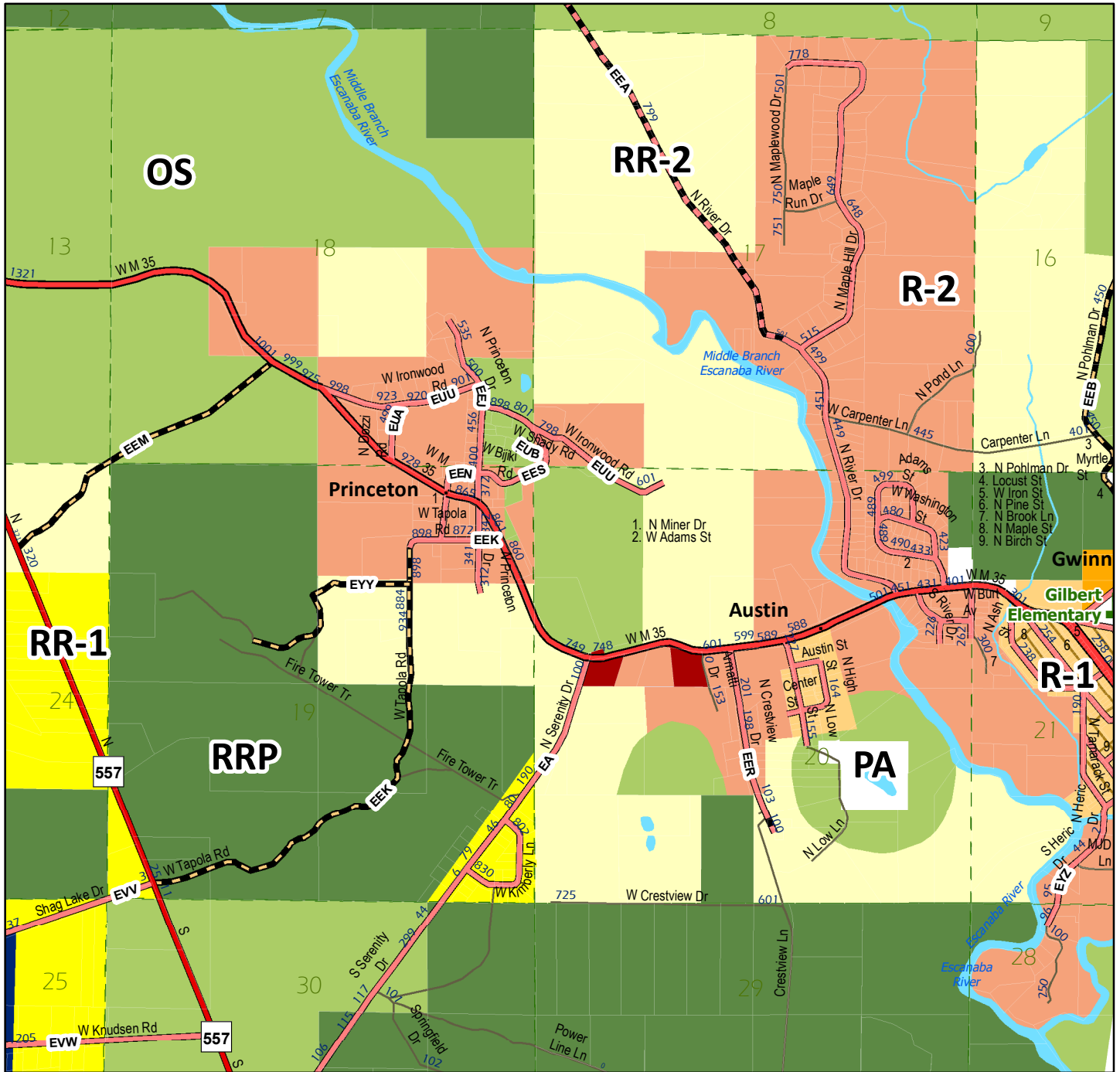

T.45N.-R.25W., Page 4

© Marquette County Resource Management / Development Department, 1.5.2025.

Forsyth Township Zoning Districts	
 C-2 Commercial	 R-2 Family Residential
 LR Lake Residential	 R-3 Multiple Family Residential
 OS Open Space	 RR-1 Rural Residential
 PA Public Area	 RR-2 Rural Residential
 R-1 Family Residential	 RRP Recreation-Resource Production

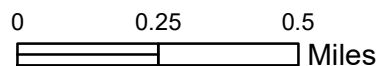
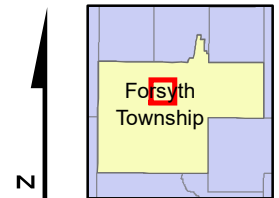

T.45N.-R.25W., Page 4

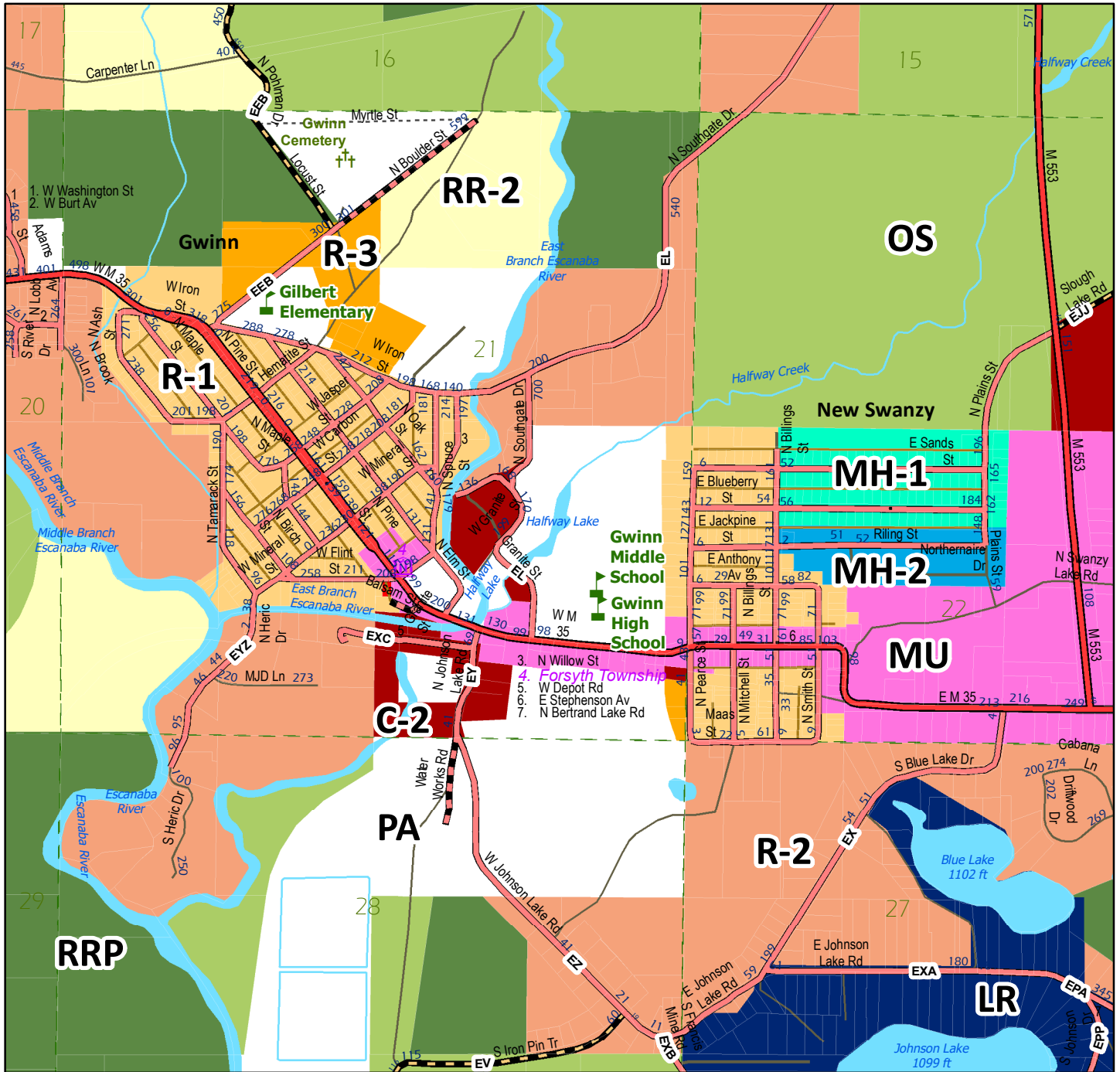

Austin/Princeton, P. 5

T.45N.-R.25W., Page 4

T.45N.-R.25W., Page 4

© Marquette County Resource Management / Development Department, 1.5.2025.

Forsyth Township Zoning Districts	
 MU Mixed Use	 PA Public Area
 C-1 Commercial	 R-1 Family Residential
 C-2 Commercial	 R-2 Family Residential
 LR Lake Residential	 R-3 Multiple Family Residential
 MH-1 Mobile Home Residential	 RR-2 Rural Residential
 MH-2 Mobile Home Park	 RRP Recreation-Resource Production
 OS Open Space	

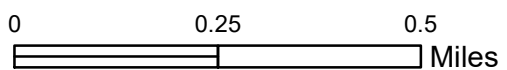
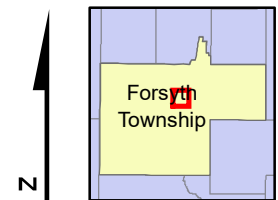

Forsyth Twp. (NE)

T.45N.-R.24W.

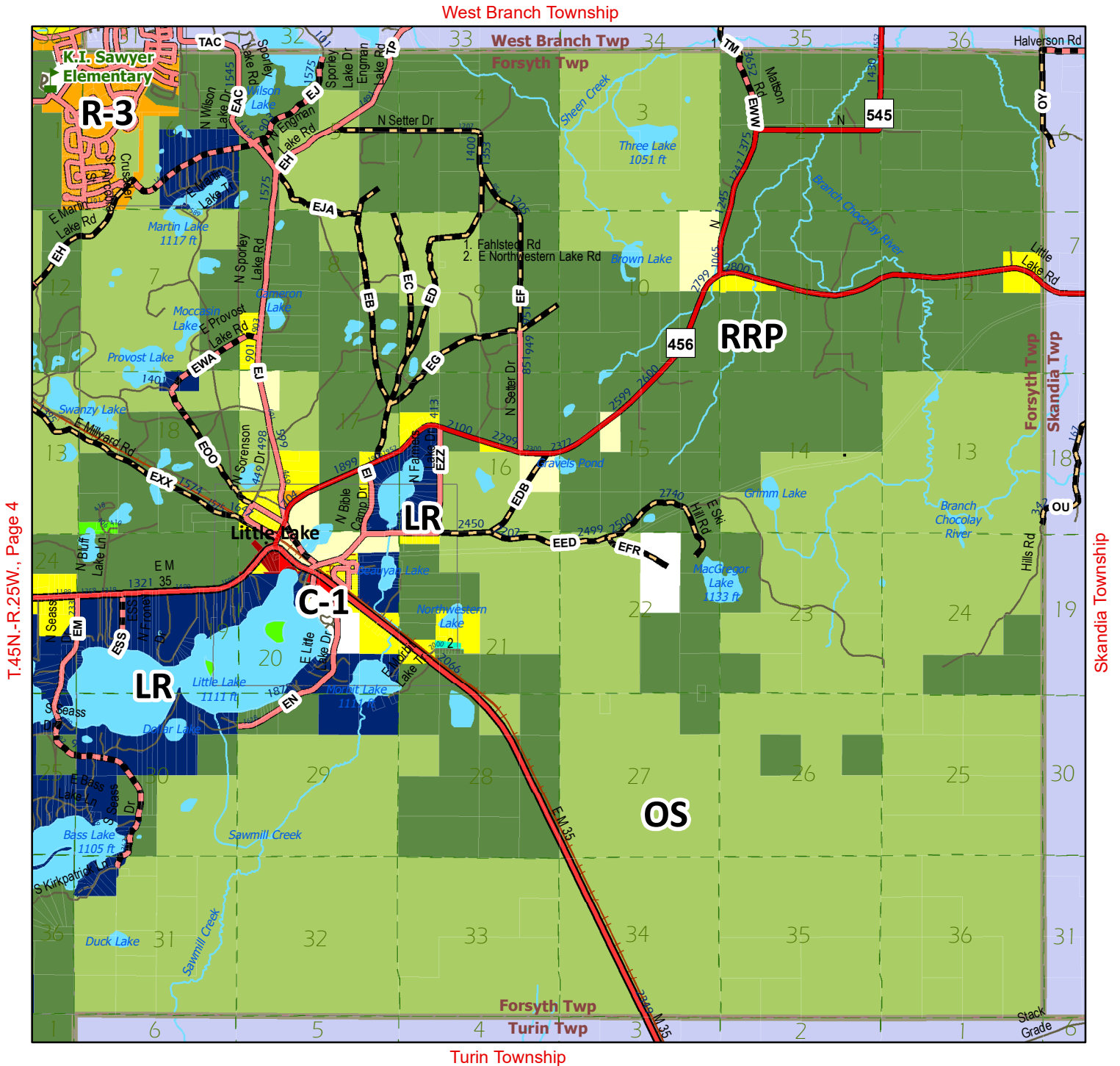

T.45N.-R.25W., Page 4

Skandia Township

© Marquette County Resource Management / Development Department, 1.5.2025.

Forsyth Township Zoning Districts	
■ C-1 Commercial	■ R-3 Multiple Family Residential
■ C-2 Commercial	■ RR-1 Rural Residential
■ LR Lake Residential	■ RR-2 Rural Residential
■ MH-1 Mobile Home Residential	■ SD Seasonal Dwelling
■ OS Open Space	■ RRP Recreation-Resource Production
■ PA Public Area	

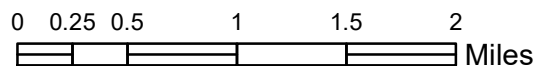
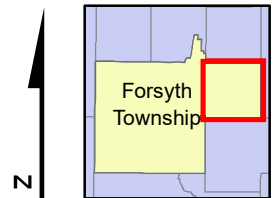

Forsyth Twp. (SW)

T.44N.-R.26W.

T.45N.-R.26W., Page 3

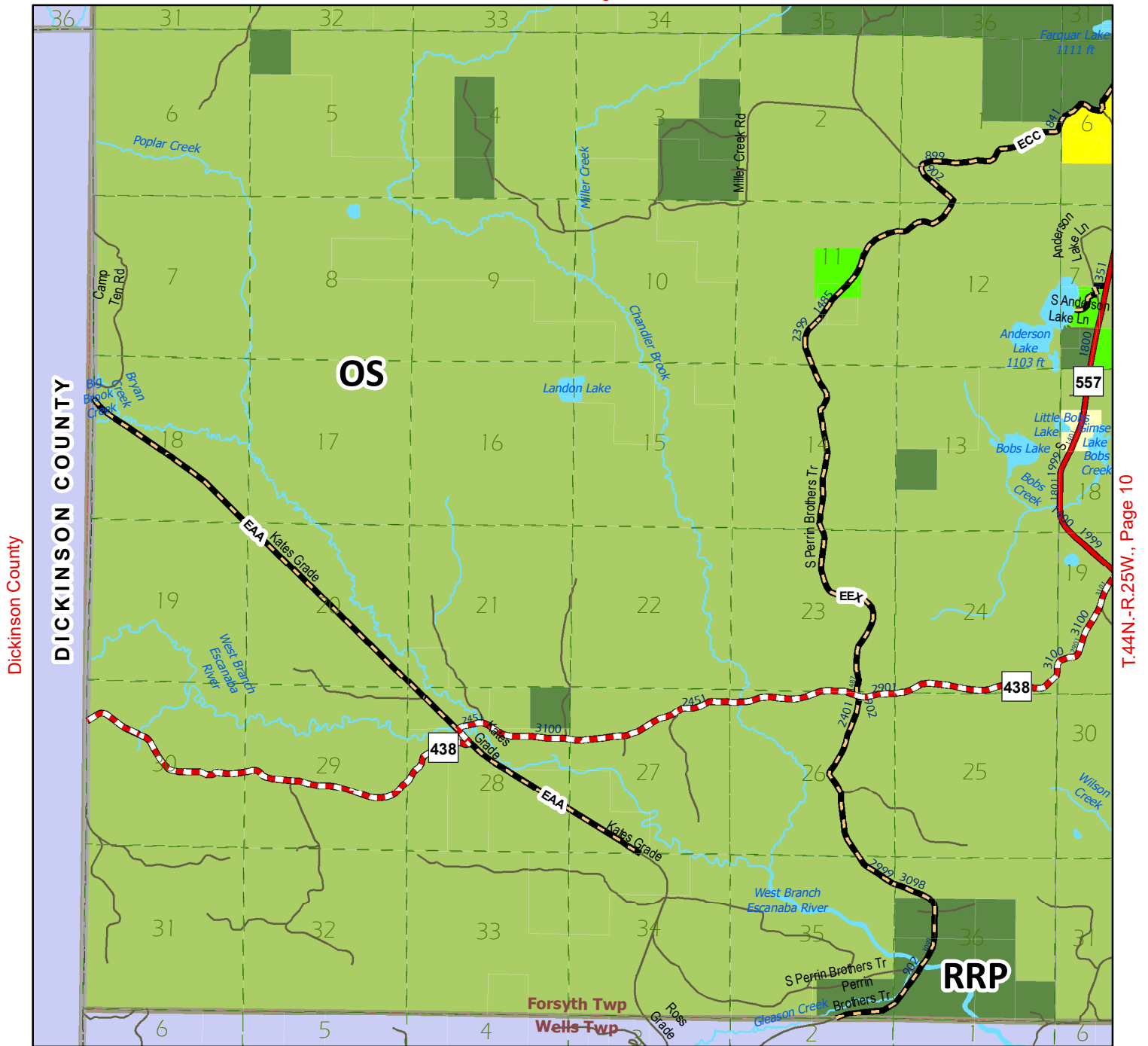

Dickinson County

T.44N.-R.25W., Page 10

Wells Township

© Marquette County Resource Management / Development Department, 1.5.2025.

Forsyth Township Zoning Districts	
 OS Open Space	 SD Seasonal Dwelling
 RR-1 Rural Residential	 RRP Recreation-Resource Production
 RR-2 Rural Residential	

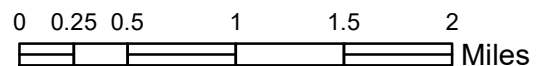
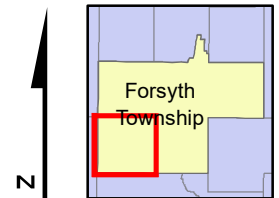

Forsyth Twp. (S Central)

T.44N.-R.25W.

T.45N.-R.25W., Page 4

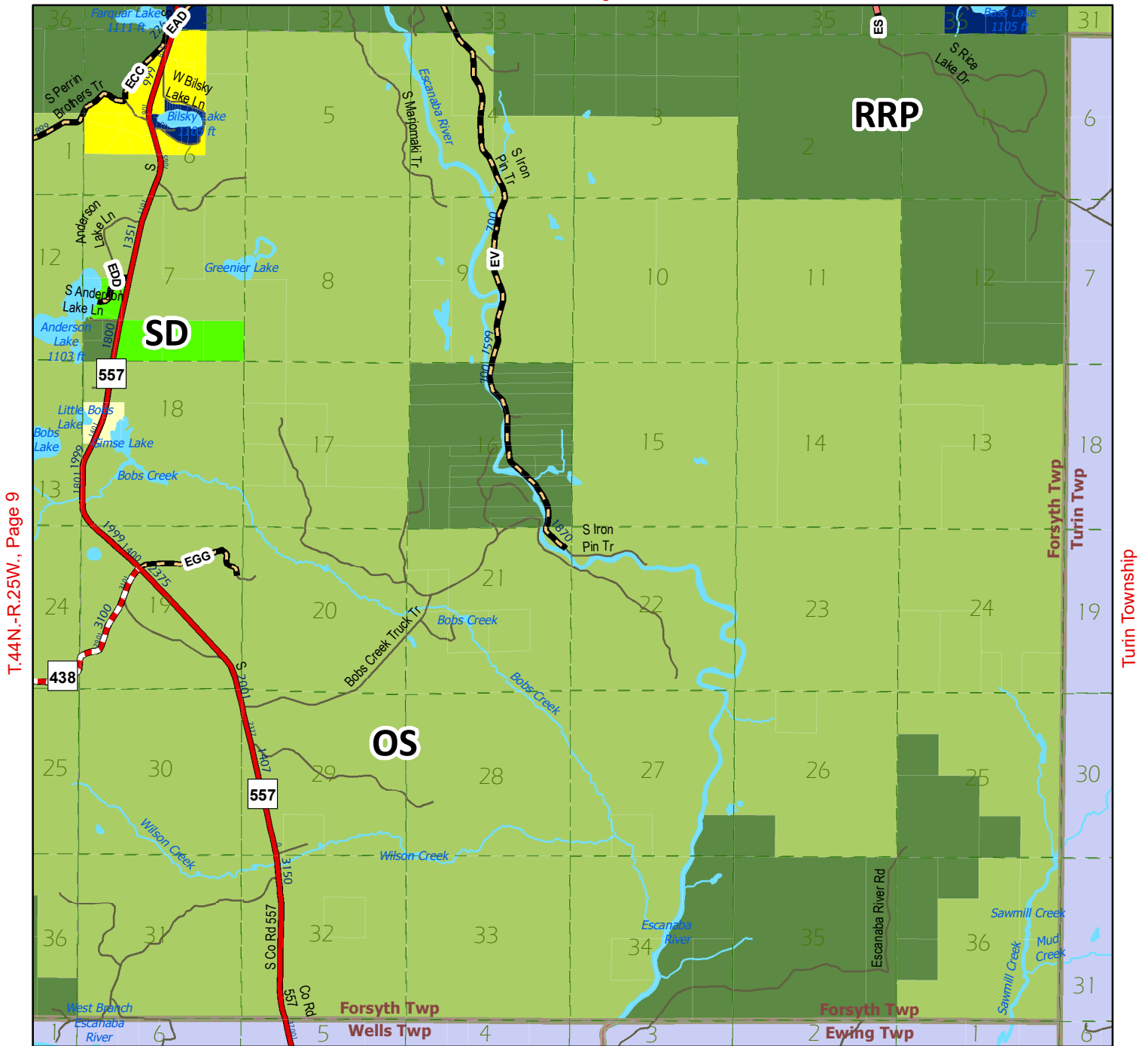

T.44N.-R.25W., Page 9

Turin Township

Wells & Ewing Townships

© Marquette County Resource Management / Development Department, 1.5.2025.

Forsyth Township Zoning Districts	
 LR Lake Residential	 RR-2 Rural Residential
 OS Open Space	 SD Seasonal Dwelling
 RR-1 Rural Residential	 RRP Recreation-Resource Production

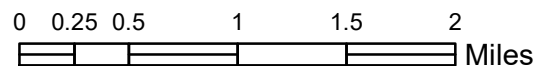
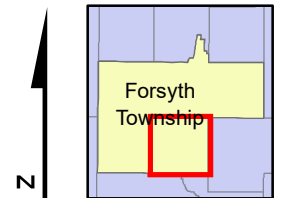

10